

CAT. No.

74901-CH16

CHINA 16 AMPERE 250 VOLT MODULAR OUTLET, 36mmX36mm SIZE, GB 2099-1, GB 1002 TYPE I (CH2-16R), 2 POLE-3 WIRE GROUNDING (2P+E), IVORY.

| | |
|----------------|--|
| APPROVALS | CCC (CHINA) <input checked="" type="checkbox"/> |
| CERTIFICATIONS | REACH <input checked="" type="checkbox"/> ROHS3 <input checked="" type="checkbox"/> CE <input checked="" type="checkbox"/> |
| STANDARDS | GB 1099-1 <input checked="" type="checkbox"/> |

ALL DIMENSIONS ARE IN MILLIMETERS

NOTE:

1. RECOMMENDED: SOLID WIRE $\phi 1.6 \sim 2.0$ OR MULTI-STRAND TINNED WIRE $2.0\text{mm}^2 \sim 3.5\text{mm}^2$.
2. OUTLET ACCEPTS 16A 250V (CH2-16P) PLUGS ONLY.
3. MOUNTS ON AMERICAN 2x4, 4x4 WALL BOXES OR PANEL MOUNT. SURFACE MOUNTS ON WALL BOXES #74225, #84225-AR.
4. MOUNTS IN "12", "3", "6", "9" CLOCK HOUR POSITIONS ON WALL PLATES/MOUNTING FRAMES.

RELATED PRODUCTS:

| CATALOG No. | DESCRIPTION |
|---------------|---|
| 74970-W | PANEL MOUNT FRAME (SNAP-IN), 1 OUTLET, IVORY |
| 74930 | PANEL MOUNT FRAME (SCREW MOUNT), 1 OUTLET, IVORY |
| 74940 | PANEL MOUNT FRAME (SCREW MOUNT), 2 OUTLETS, IVORY |
| 74950 | SURFACE MOUNT FRAME (SCREW MOUNT), 1 OUTLET, IVORY |
| 74960 | SURFACE MOUNT FRAME (SCREW MOUNT), 2 OUTLETS, IVORY |
| 74910 | WALL BOX (2x4) MOUNT, 1 OUTLET, IVORY |
| 74920 | WALL BOX (2x4) MOUNT, 2 OUTLETS, IVORY |
| 74925 | WALL BOX (4x4) MOUNT, 4 OUTLETS, IVORY |
| 58206 | POWER STRIP, 6 OUTLETS, IVORY |
| 58206-C14 | POWER STRIP, 6 OUTLETS, C-14 INLET, IVORY |
| 58206-C14-USB | POWER STRIP, 4 OUTLETS, 2 USB, C-14 INLET, IVORY |
| 58205 | POWER STRIP, 5 OUTLETS, IVORY |
| 58205-C14 | POWER STRIP, 5 OUTLETS, C-14 INLET, IVORY |
| 58204-C14 | POWER STRIP, 4 OUTLETS, C-14 INLET, BLACK |
| 58208-C14 | POWER STRIP, 8 OUTLETS, C-14 INLET, BLACK |

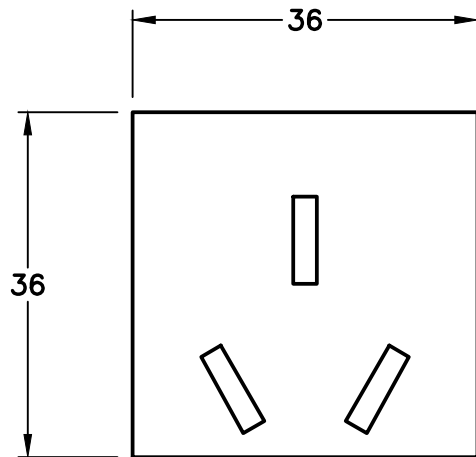

FRONT VIEW

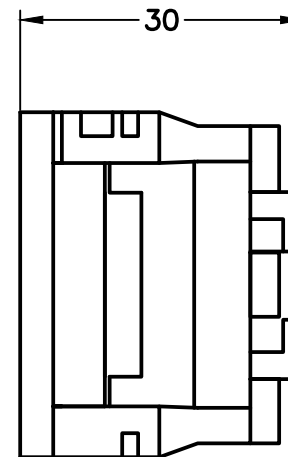

SIDE VIEW