

CAT. No.

74901-C13

IEC 60320 C-13 MODULAR POWER OUTLET, 15 AMPERE 250 VOLT, 50/60Hz, 36mmX36mm SIZE, \*\*4.8x0.8mm SPADE TERMINALS, 2 POLE-3 WIRE GROUNDING (2P+E). BLACK.

APPROVALS	UL <input checked="" type="checkbox"/> CSA <input checked="" type="checkbox"/> 15A-250V AC <input checked="" type="checkbox"/> TUV <input checked="" type="checkbox"/> CCC <input checked="" type="checkbox"/> KTL <input checked="" type="checkbox"/> 10A-250V AC <input checked="" type="checkbox"/>
CERTIFICATIONS	REACH <input checked="" type="checkbox"/> ROHS <input checked="" type="checkbox"/> CE <input checked="" type="checkbox"/>
STANDARDS	UL 60320 <input checked="" type="checkbox"/> CSA 22.2.42M <input checked="" type="checkbox"/> IEC/EN60320 <input checked="" type="checkbox"/>

ALL DIMENSIONS ARE IN MILLIMETERS

**NOTE:**

1. \*\*TERMINALS REQUIRE "INSULATED" Q.C. CONNECTORS.
2. MOUNTS ON AMERICAN 2x4, 4x4 WALL BOXES OR PANEL MOUNT. SURFACE MOUNTS ON WALL BOXES #74225, #84225-AR.
3. MOUNTS IN "12", "3", "6", "9" CLOCK HOUR POSITIONS ON WALL PLATES/MOUNTING FRAMES.

**RELATED PRODUCTS:**

CATALOG No.	DESCRIPTION
74970-W	PANEL MOUNT FRAME (SNAP-IN), 1 OUTLET, IVORY
74930	PANEL MOUNT FRAME (SCREW MOUNT), 1 OUTLET, IVORY
74940	PANEL MOUNT FRAME (SCREW MOUNT), 2 OUTLETS, IVORY
74950	SURFACE MOUNT FRAME (SCREW MOUNT), 1 OUTLET, IVORY
74960	SURFACE MOUNT FRAME (SCREW MOUNT), 2 OUTLETS, IVORY
74910	WALL BOX (2x4) MOUNT, 1 OUTLET, IVORY
74920	WALL BOX (2x4) MOUNT, 2 OUTLETS, IVORY
74925	WALL BOX (4x4) MOUNT, 4 OUTLETS, IVORY
58206	POWER STRIP, 6 OUTLETS, IVORY
58206-C14	POWER STRIP, 6 OUTLETS, C-14 INLET, IVORY
58206-C14-USB	POWER STRIP, 4 OUTLETS, 2 USB, C-14 INLET, IVORY
58205	POWER STRIP, 5 OUTLETS, IVORY
58205-C14	POWER STRIP, 5 OUTLETS, C-14 INLET, IVORY
58204-C14	POWER STRIP, 4 OUTLETS, C-14 INLET, BLACK
58208-C14	POWER STRIP, 8 OUTLETS, C-14 INLET, BLACK

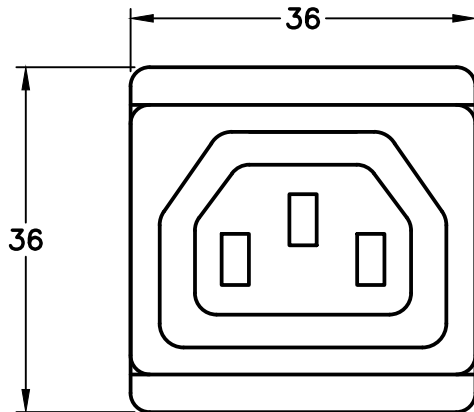

FRONT VIEW

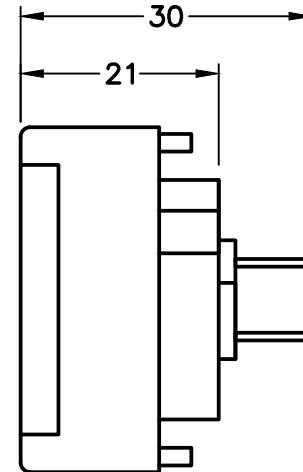

SIDE VIEW