

CAT. No.

57345

IEC 60320 C-13 POWER OUTLET, 15 AMPERE 250 VOLT AND 10 AMPERE 250 VOLT, SNAP-IN MOUNT FOR 1.5 mm THICK PANEL, 4.8 x 0.8 mm (0.189" x 0.032") QUICK CONNECT Q.D. TERMINALS, 2 POLE-3 WIRE GROUNDING, IP30 RATED, BLACK.

APPROVALS	C(UR)US <input checked="" type="checkbox"/> ENEC 10 <input checked="" type="checkbox"/> CCC <input checked="" type="checkbox"/> VDE <input checked="" type="checkbox"/> UL <input checked="" type="checkbox"/>
CERTIFICATIONS	REACH <input checked="" type="checkbox"/> ROHS <input checked="" type="checkbox"/> ROHS2 (2011/65/EU) <input checked="" type="checkbox"/> ROHS3 (2015/863, 2017/2012) <input checked="" type="checkbox"/> CHINA ROHS <input checked="" type="checkbox"/> CE <input checked="" type="checkbox"/> UKCA <input checked="" type="checkbox"/>
STANDARDS	IEC 60320 C-13 <input checked="" type="checkbox"/> IEC 60320-1 <input checked="" type="checkbox"/> IEC 60320-3 <input checked="" type="checkbox"/> UL 60320-1 <input checked="" type="checkbox"/> CSA C22.2 No. 60320-1 <input checked="" type="checkbox"/>

**DESCRIPTION:**

PANEL MOUNT: SNAP-IN MOUNTING FROM FRONT SIDE  
CONNECTOR, PIN TEMPERATURE 70°C, PROTECTION CLASS I

ALL DIMENSIONS ARE IN MILLIMETERS

**TECHNICAL DATA:**

RATINGS IEC: 10A/250VAC; 50HZ  
RATINGS UL/CSA: 15A/250VAC; 60HZ  
DIELECTRIC STRENGTH: >2KVAC BETWEEN L-N  
>2KVAC BETWEEN L/N-PE  
(1MIN/50HZ)  
ALLOWABLE OPERATION TEMP: -25°C TO +70°C  
DEGREE OF PROTECTION: FROM FRONT SIDE IP30 ACC TO IEC 60529  
PROTECTION CLASS: SUITABLE FOR APPLIANCES WITH PROTECTION  
CLASS I ACC TO IEC 61140  
MATERIAL, HOUSING: THERMOPLASTIC, BLACK, UL 94V-0

**ADDITIONAL SIZES:**

CATALOG No	DESCRIPTION
57345X1.0M	1.0mm THICK PANELS
57345X1.2M	1.2mm THICK PANELS
57345X2.0M	2.0mm THICK PANELS
57345X2.5M	2.5mm THICK PANELS
57345X3.0M	3.0mm THICK PANELS

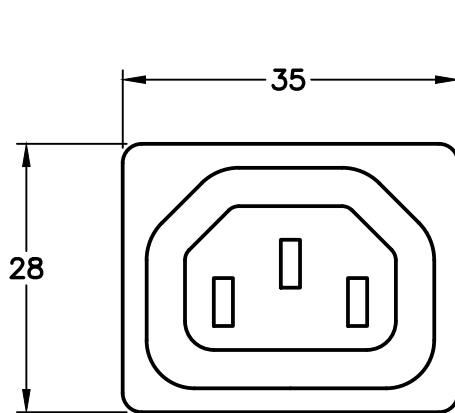

**IEC 60320 C-13  
FRONT VIEW**

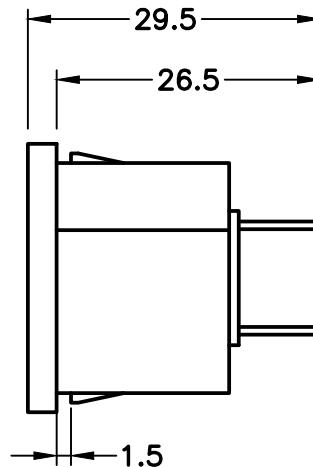

**SIDE VIEW**

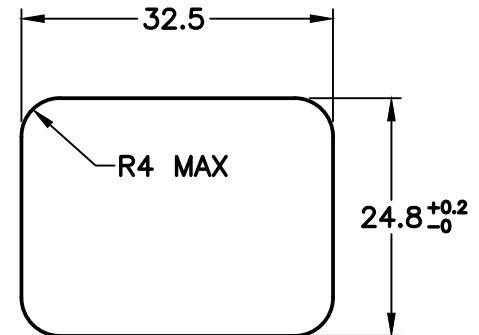

**MOUNTING  
DIMENSIONS**