

CAT. No. 57321	IEC 60320 C-16 POWER INLET, 10 AMPERE 250 VOLT AND 15 AMPERE 250 VOLT, SNAP-IN MOUNT FOR 1.5 mm THICK PANEL, THERMOPLASTIC POLYAMID 6.6, BRASS TIN PLATED TERMINALS AND CONTACTS, 6.3 x 0.8 mm (0.250" x 0.032") QUICK CONNECT Q.D. TERMINALS, 2 POLE-3 WIRE GROUNDING, BLACK.
--------------------------	--

APPROVALS	C(UR)US <input checked="" type="checkbox"/> ENEC 10 <input checked="" type="checkbox"/> CCC <input checked="" type="checkbox"/> VDE <input checked="" type="checkbox"/> UL <input checked="" type="checkbox"/>
CERTIFICATIONS	REACH <input checked="" type="checkbox"/> ROHS <input checked="" type="checkbox"/> ROHS2 (2011/65/EU) <input checked="" type="checkbox"/> ROHS3 (2015/863, 2017/2012) <input checked="" type="checkbox"/> CHINA ROHS <input checked="" type="checkbox"/> CE <input checked="" type="checkbox"/> UKCA <input checked="" type="checkbox"/>
STANDARDS	IEC 60320 C-16 <input checked="" type="checkbox"/> IEC 60320-1 <input checked="" type="checkbox"/> UL 60320-1 <input checked="" type="checkbox"/> CSA C22.2 No. 60320-1 <input checked="" type="checkbox"/>

DESCRIPTION:

PANEL MOUNT: SNAP-IN MOUNTING FROM FRONT SIDE
 APPLIANCE INLET, PIN TEMPERATURE 120°C, PROTECTION CLASS I

ALL DIMENSIONS ARE IN MILLIMETERS

TECHNICAL DATA:

RATINGS IEC: 10A/250VAC; 50HZ
 RATINGS UL/CSA: 15A/250VAC; 60HZ
 DIELECTRIC STRENGTH: >2KVAC BETWEEN L-N
 >2KVAC BETWEEN L/N-PE (1MIN/50HZ)
 ALLOWABLE OPERATION TEMP: -25°C TO +120°C
 DEGREE OF PROTECTION: FROM FRONT SIDE IP30 ACC TO IEC 60529
 PROTECTION CLASS: SUITABLE FOR APPLIANCES WITH PROTECTION CLASS I ACC TO IEC 61140
 MATERIAL, HOUSING: THERMOPLASTIC, BLACK, UL 94V-0

ADDITIONAL SIZES:

CATALOG No	DESCRIPTION
57321X1.0M	1.0mm THICK PANELS
57321X1.2M	1.2mm THICK PANELS
57321X2.0M	2.0mm THICK PANELS
57321X2.5M	2.5mm THICK PANELS
57321X3.0M	3.0mm THICK PANELS

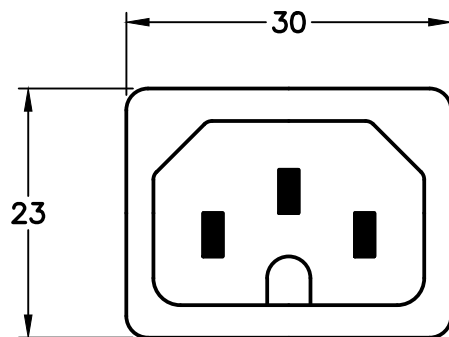

**IEC 60320 C-16
FRONT VIEW**

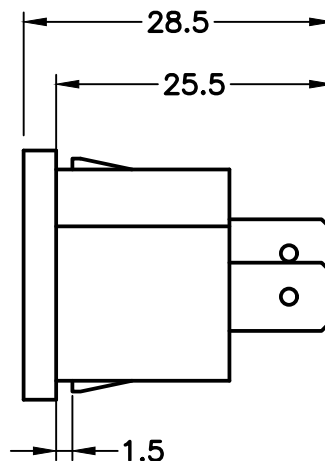

SIDE VIEW

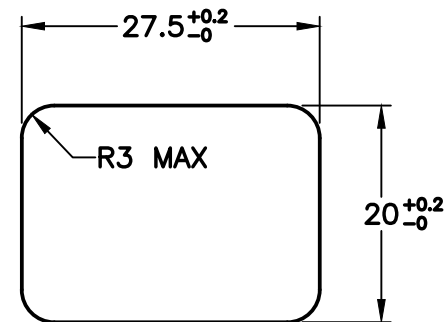

**MOUNTING
DIMENSIONS**