

CAT. No.

57320

IEC 60320 C-13 POWER OUTLET, 15 AMPERE 250 VOLT AND 10 AMPERE 250 VOLT, SNAP-IN MOUNT FOR 1.5 mm THICK PANEL, 6.3 x 0.8 mm (0.250" x 0.032") QUICK CONNECT Q.D. TERMINALS, 2 POLE-3 WIRE GROUNDING, IP30 RATED, BLACK.

APPROVALS

C(UR)US ENEC 10 CCC VDE UL

CERTIFICATIONS

REACH ROHS ROHS2 (2011/65/EU) ROHS3 (2015/863, 2017/2012) CHINA ROHS CE UKCA

STANDARDS

IEC 60320 C-13 IEC 60320-1 IEC 60320-3 UL 60320-1 CSA C22.2 No. 60320-1

DESCRIPTION:

PANEL MOUNT: SNAP-IN MOUNTING FROM FRONT SIDE
CONNECTOR, PIN TEMPERATURE 70°C, PROTECTION CLASS I

ALL DIMENSIONS ARE IN MILLIMETERS

TECHNICAL DATA:

RATINGS IEC: 10A/250VAC; 50HZ
RATINGS UL/CSA: 15A/250VAC; 60HZ
DIELECTRIC STRENGTH: >2KVAC BETWEEN L-N
>2KVAC BETWEEN L/N-PE
(1MIN/50HZ)

ALLOWABLE OPERATION TEMP: -25°C TO +70°C
DEGREE OF PROTECTION: FROM FRONT SIDE IP30 ACC TO IEC 60529
PROTECTION CLASS: SUITABLE FOR APPLIANCES WITH PROTECTION CLASS I ACC TO IEC 61140

MATERIAL, HOUSING: THERMOPLASTIC, BLACK, UL 94V-0

ADDITIONAL SIZES:

CATALOG No	DESCRIPTION
57320X1.0M	1.0mm THICK PANELS
57320X1.2M	1.2mm THICK PANELS
57320X2.0M	2.0mm THICK PANELS
57320X2.5M	2.5mm THICK PANELS
57320X3.0M	3.0mm THICK PANELS

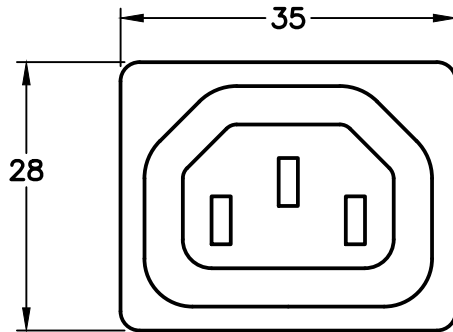

FRONT VIEW

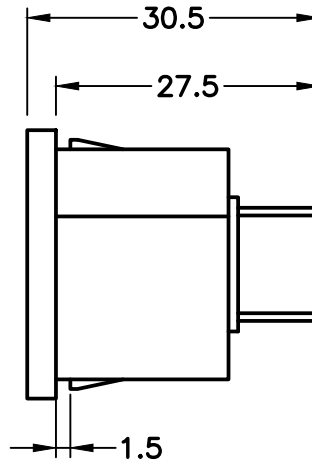

SIDE VIEW

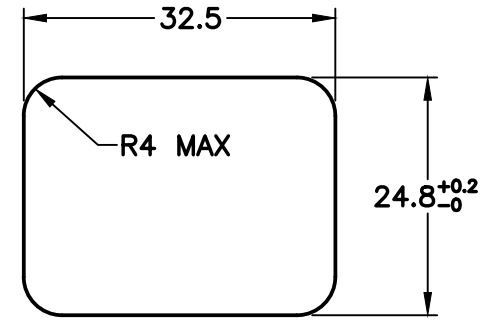

MOUNTING DIMENSIONS